

CandlesPro

Sonoff THR320D Smartphone Setup Manual

Step-by-step pairing guide for candle machines with smartphone control

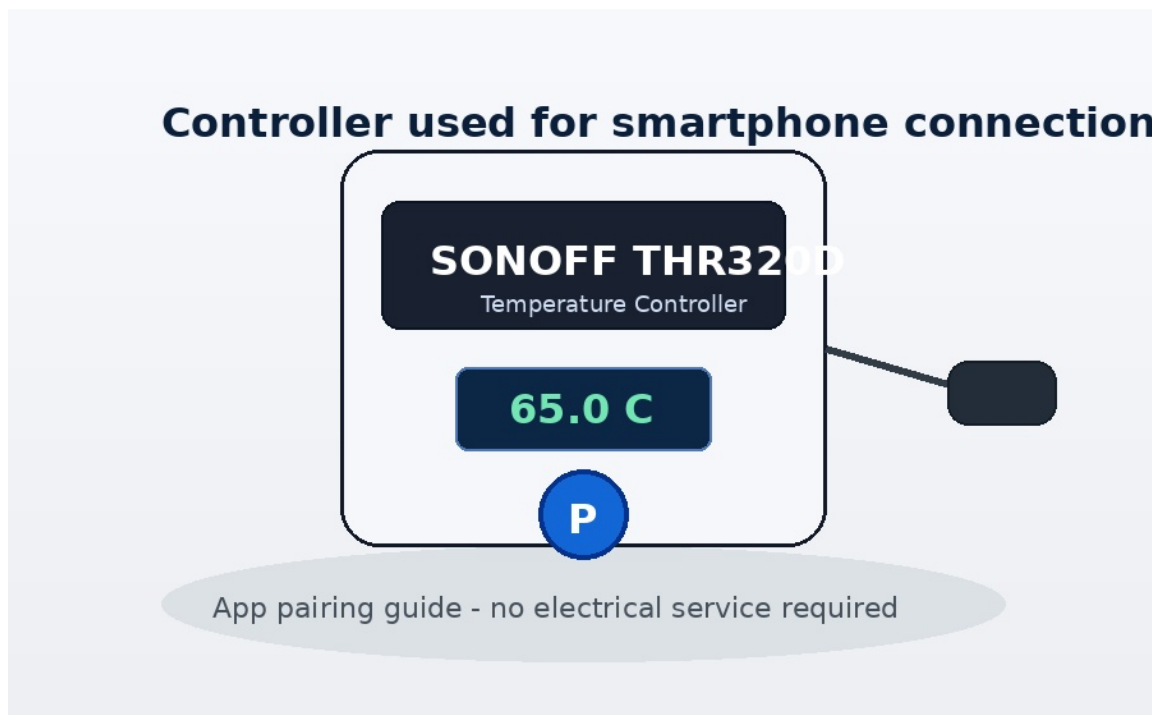

Purpose: This manual helps you connect the Sonoff THR320D controller to the eWeLink app so you can monitor and control the machine from your smartphone.

Important: This guide is for app pairing only. Do not open or modify electrical wiring unless you are qualified.

1. Before You Start



Safety first

- Do not open the electrical box while power is connected.
- Pairing is done from the app and the Sonoff button only.
- Use a qualified electrician for wiring or service work.

Need	Why it matters
eWeLink app installed	The Sonoff controller is paired through the eWeLink app.
2.4 GHz WiFi network	Sonoff WiFi setup requires 2.4 GHz. 5 GHz usually fails.
Bluetooth ON	Helps the app find the device during pairing.
Phone close to machine	Weak signal can interrupt pairing.
Correct WiFi password	One wrong character will stop pairing.

Step 1 - Install the eWeLink App

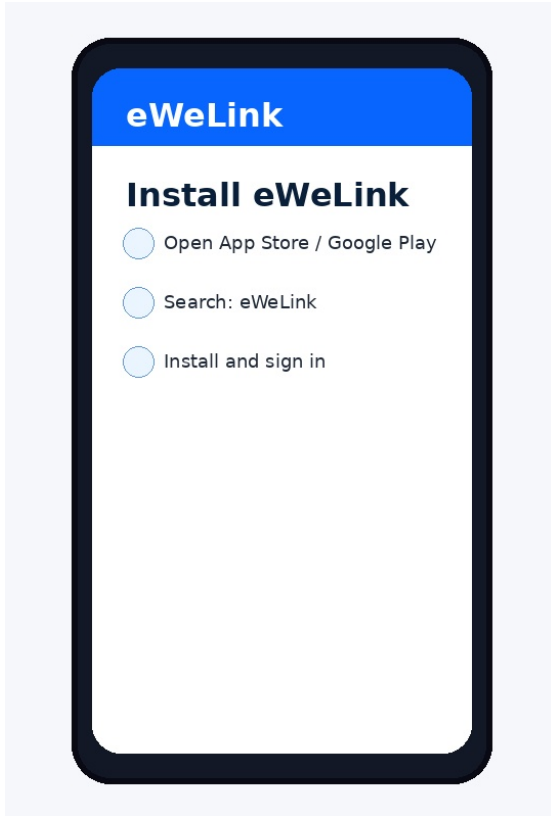

On your phone, open the App Store or Google Play, search for eWeLink, install the app, and sign in or create an account.

Tip: Stay close to the machine during setup and keep the phone unlocked until the pairing process finishes.

Step 2 - Put the Sonoff Device in Pairing Mode

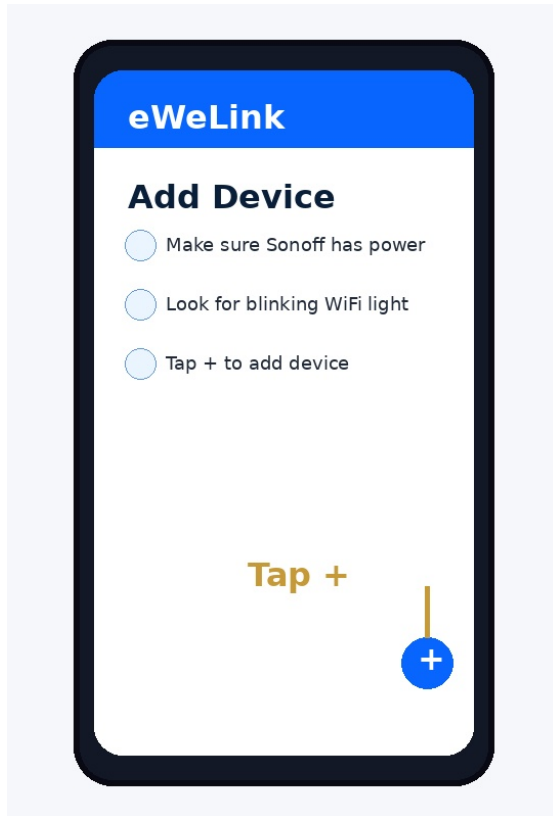

Power on the machine and the Sonoff controller. The WiFi indicator should blink. If it is not blinking, hold the Sonoff button for about 5 seconds until it enters pairing mode.

Tip: Stay close to the machine during setup and keep the phone unlocked until the pairing process finishes.

Step 3 - Add the Device in eWeLink

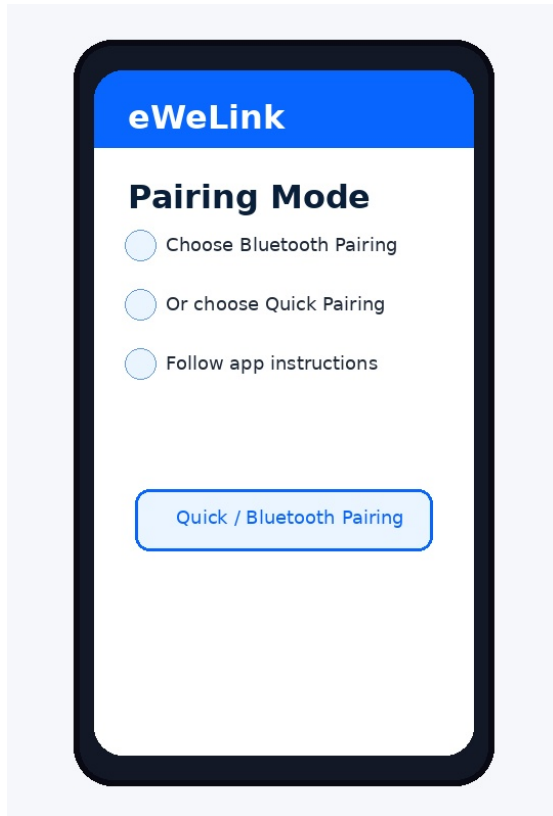

Open eWeLink, tap the + button, then select Bluetooth Pairing or Quick Pairing. Follow the prompts in the app.

Tip: Stay close to the machine during setup and keep the phone unlocked until the pairing process finishes.

Step 4 - Connect to 2.4 GHz WiFi

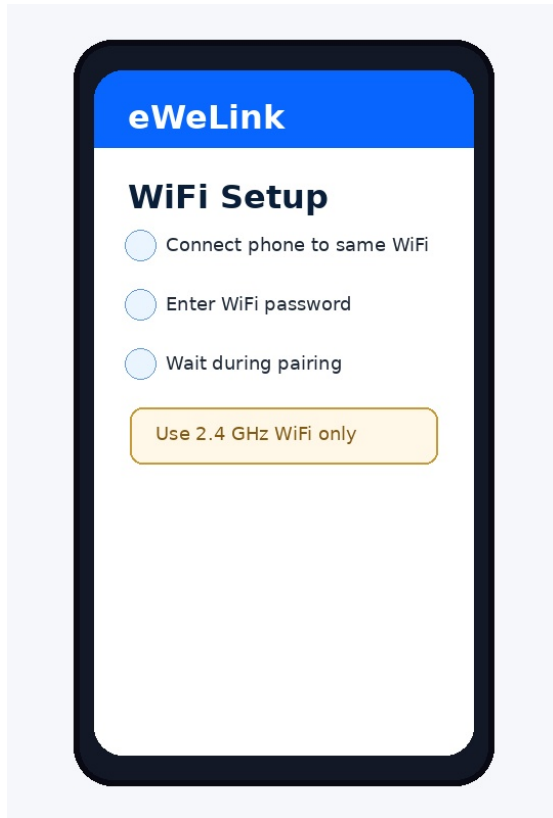

Select your WiFi network and enter the password. Use a 2.4 GHz WiFi network. If your router has both 2.4 GHz and 5 GHz, connect the phone to the 2.4 GHz network before pairing.

Key rule: Most pairing failures happen because the phone/router is using 5 GHz WiFi. Switch to 2.4 GHz and try again.

Step 5 - Finish and Test Control

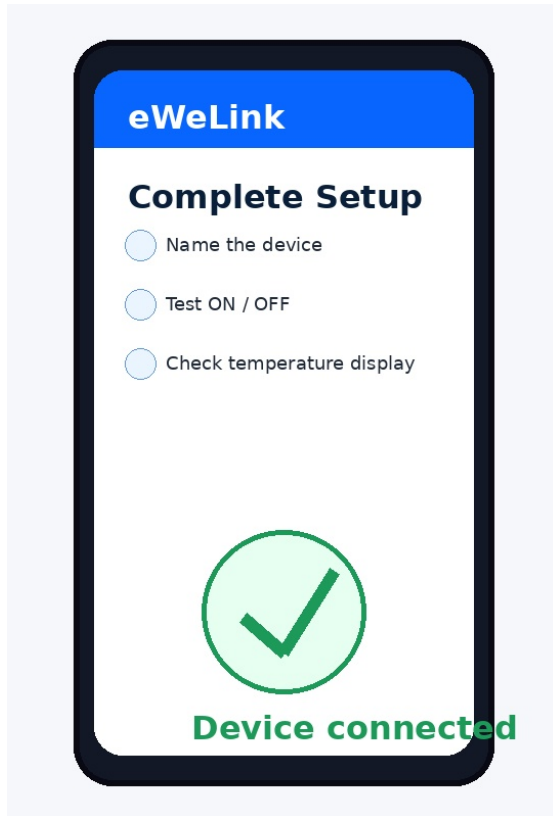

When the app shows the device is connected, rename it if you want. Test ON/OFF control and check that temperature information appears correctly.

Tip: Stay close to the machine during setup and keep the phone unlocked until the pairing process finishes.

2. Troubleshooting

Most pairing problems are caused by WiFi

1

Phone connected to 5 GHz

Switch phone to 2.4 GHz WiFi

2

Weak WiFi signal

Move closer to router

3

Device not blinking

Hold Sonoff button 5 seconds

4

Password mistake

Re-enter WiFi password

Problem	What to do
The app cannot find the device	Make sure Bluetooth is ON, WiFi is 2.4 GHz, and the Sonoff LED is blinking.
Pairing stops or fails	Move the phone closer to the machine and router. Check the WiFi password.
The LED is not blinking	Hold the Sonoff button for about 5 seconds to reset into pairing mode.
The router has one WiFi name only	Some routers combine 2.4 GHz and 5 GHz. Temporarily disable 5 GHz or create a separate 2.4 GHz network.
Video instructions do not work	Use this written manual. Send us a screenshot of the step where you are stuck.